

ROAD SAFETY RENTAL

Product Catalogue 2024

DRIVEN BY INNOVATION

[ROADSAFETYRENTAL.COM.AU](https://roadsafetyrental.com.au)



Why Choose Road Safety Rental?

The Work Zone Specialists

We are a dedicated team with a passion for road safety and reducing Australia's road toll. The team at Road Safety Rental don't just supply the equipment - our multidisciplinary team of engineers, health and safety specialists, project managers and installation/operations experts will make sure your project runs safely and efficiently.

Road Safety Rental specialise in the deployment of temporary barriers to ensure the safety of construction and infrastructure works, so you can rely on our expertise and continue your project with confidence.

Don't take our word for it...

What our customers are saying

"Road Safety Rental made the entire process easy and well managed. Their great communication created peace of mind and ability to carry on with other aspects of the project without concern around barriers."

"The Road Safety Rental team did a fantastic job installing 400 metres of Ironman Hybrid Barrier on our Burwood Highway project during night works, despite a very tight window. A great standard of safety and quality."



Daniel Tribe
TRN Group
Product: T-Lok Barrier



Ruan Dippenaar
Project Engineer Fulton Hogan
Product: Ironman Hybrid Barrier



Contents



TEMPORARY BARRIERS

HV2 Barrier	5
Ironman Hybrid Barrier	6
T-Lok Barrier	8



END TREATMENTS

ABSORB 350	11
SLED	12
QuadGuard M10 CZ	13



VMS

Variable Message Sign - Amber	15
Variable Message Sign - 5 Colour	16



LIGHTING & SECURITY

V20 Work Zone Light Tower	18
Portable Solar Light	19



EVENT SECURITY

BIG Blockout	21
OmniStop Portable System	22



Temporary Barriers



HV2 Barrier



The HV2 Barrier is the world's first unanchored barrier to successfully achieve MASH TL-4.

It is a longitudinal barrier system with low deflection and high containment, showing incredible stability whilst being crash tested with a 10,000kg truck.

Cost-effective to transport and deploy, HV2 Barrier features patented hybrid technology. Unique connectors allow this barrier to be freestanding whilst offering high containment and low deflection.

We offer a turn-key barrier rental solution and all deployments will be solely managed and certified by the Road Safety Rental team.

SPECIFICATIONS

Effective Length	5.8m
Height	900mm
Width	450mm
Weight	2088kg
Weight Per Metre	360kg
Successfully Tested To	MASH TL-4
ASBAP Approval To	100km/h
MASH TL-3 Deflection	1.47m
MASH TL-4 Deflection	2.37m
Amount Transportable Per Semi Truck	10
Multiple End Treatments Can Be Used	Yes
Lightweight	Yes
High Containment	Yes
Safe Redirection	Yes
Fast Deployment/Retrieval	Yes
No Anchoring Required	Yes
Economical To Transport	Yes
Maintenance Free	Yes
Durable	Yes

- ✓ **ASBAP approval to 100km/h**
- ✓ Freestanding barrier
- ✓ High containment
- ✓ Safe redirection
- ✓ Superior deployment and retrieval
- ✓ No anchoring required
- ✓ Economical to transport
- ✓ Lightweight

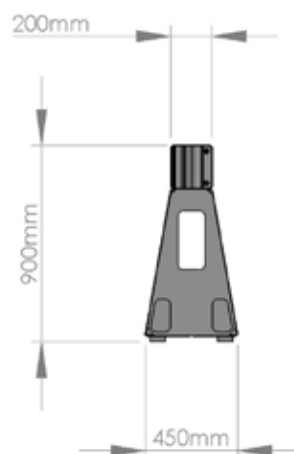

Approved by

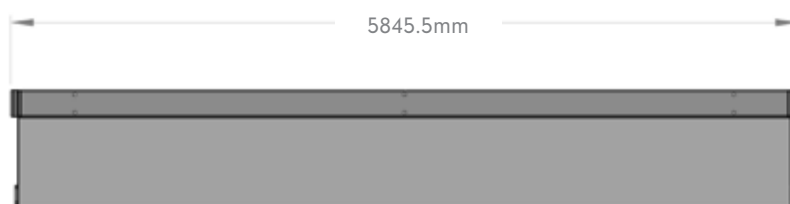

Ironman Hybrid Barrier



SPECIFICATIONS

Effective Length	4.15m
Height	813mm
Width	546mm
Weight	925kg
Weight Per Metre	225kg
Successfully Tested To	MASH TL-2
ASBAP Approval To	70km/h
MASH TL-2 Deflection	1.49m
Amount Transportable Per Semi Truck	24
Multiple End Treatments Can Be Used	Yes
Sight/Debris Screen Options Bolt On	Yes (subject to site assessment)
Lightweight	Yes
High Containment	No
Safe Redirection	Yes
Fast Deployment/Retrieval	Yes
No Anchoring Required	Yes
Economical To Transport	Yes
Maintenance Free	Yes
Durable	Yes

The Ironman Hybrid Barrier is an innovative option that offers excellent flexibility for 40 and 60km/h projects. It's a freestanding temporary longitudinal barrier system crash tested to MASH TL-2.

This steel barrier has an Austroads Safety Barrier Assessment Panel (ASBAP) approval to 70km/h. It's lightweight and stackable design offers transport cost savings when compared to traditional concrete barriers. Our fleet consists of only Hybrid Ironman and we have successfully installed over 150km of product since our rental business commenced.

We offer a turn-key barrier rental solution and all deployments will be solely managed and certified by the Road Safety Rental team.

- ✓ **ASBAP approval to 70km/h**
- ✓ Freestanding barrier
- ✓ Safe redirection
- ✓ Fast deployment and retrieval
- ✓ No anchoring required
- ✓ Maintenance free
- ✓ Multiple end treatments can be used
- ✓ Can deploy more of this than any other barrier with a 3-man crew
- ✓ Durable
- ✓ Economical to transport
- ✓ Lightweight
- ✓ Can be deployed with Steel Wedge (engineered angle pieces) to accommodate tight radius projects

Approved by



Ironman Hybrid Barrier

RADIUS SOLUTION FOR IRONMAN HYBRID BARRIERS

Ironman Hybrid Barriers can be deployed with a Steel Wedge (engineered angle pieces) to accommodate continuous traffic barrier deployment on tight radius projects. The Steel Wedge piece is incorporated in-between individual Ironman Hybrid temporary barriers allowing placement at tighter radii, offering a significant advantage over traditional barrier deployments where, on approved projects, the radius can be as tight as 10m.

- ✓ ASBAP approval to 60km/h
- ✓ Facilitates placement of Ironman Hybrid Barriers at tighter radii
- ✓ Enables the Ironman Hybrid barrier to be deployed on a radius as tight as 10m
- ✓ 5m design deflection where wedges are used
- ✓ Improved efficiency during staged intersection deployment
- ✓ No compromise on worksite protection



T-Lok Barrier



The T-Lok Barrier is a precast concrete F-type barrier successfully crash tested to MASH TL-3 with an Austroads Safety Barrier Assessment Panel (ASBAP) approval to 100km/h.

The barrier offers the lowest deflection result of any approved freestanding TL-3 barrier system.

Anti-gawk / debris screens can be fitted to the barriers providing additional protection for workers and motorists.

Road Safety Rental offers a dedicated 3.6m T-Lok barrier fleet for the ultimate in flexibility, accommodating radii as low as 30m. Our turn-key barrier rental solution and all deployments will be solely managed and certified by our qualified Road Safety Rental team.

SPECIFICATIONS

Effective Length	3.66m
Height	810mm
Width	610mm
Weight	2600kg
Weight Per Metre	722kg
Successfully Tested To	MASH TL-3
ASBAP Approval To	100km/h
MASH TL-3 Deflection	1.27m
Amount Transportable Per Semi Truck	9
Multiple End Treatments Can Be Used	Yes
Sight/Debris Screen Options Bolt On	Yes
Lightweight	No
High Containment	No
Safe Redirection	Yes
Fast Deployment/Retrieval	Yes
No Anchoring Required	Yes
Economical To Transport	No
Maintenance Free	Yes
Durable	No

- ✓ **ASBAP approval to 100km/h**
- ✓ Freestanding barrier
- ✓ Low deflection
- ✓ Safe redirection
- ✓ Fast deployment and retrieval
- ✓ No anchoring required
- ✓ Maintenance free
- ✓ Multiple end treatments can be used
- ✓ Sight / debris screen options bolt on
- ✓ Can be deployed with Steel Wedge (engineered angle pieces) to accommodate tight radius projects



Approved by



T-Lok Barrier

RADIUS SOLUTION FOR T-LOK BARRIERS

T-Lok Barriers can be deployed with a Steel Wedge (engineered angle pieces) to accommodate continuous traffic barrier deployment on tight radius projects. The Steel Wedge piece is used in-between individual T-Lok freestanding concrete barriers to facilitate placement at tighter radii, offering a significant advantage over traditional barrier deployments where, on approved projects, the radius can be as tight as 8m.

- ✓ **ASBAP approval to 60km/h**
- ✓ Facilitates placement of T-Lok Barriers at tighter radii
- ✓ Enables the T-Lok 3.66m barrier to be deployed on a radius as tight as 8m
- ✓ 5m design deflection where wedges are used
- ✓ Improved efficiency during staged intersection deployment
- ✓ Vast improvement in safety during construction periods

RADIUS ACHIEVED WITH STEEL WEDGE

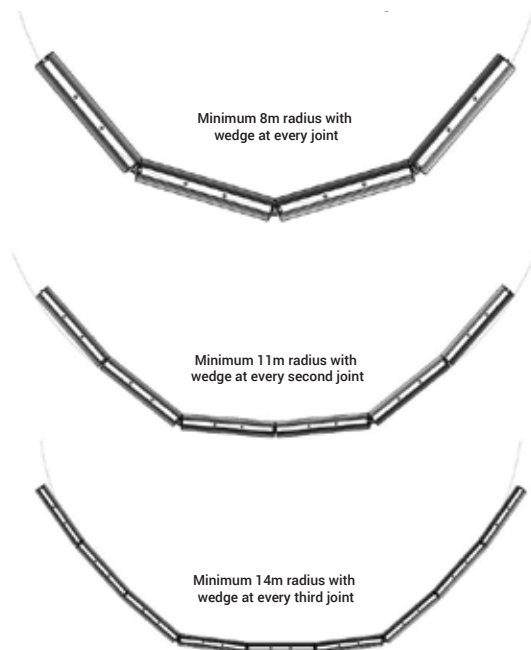

T-Lok 3.66m

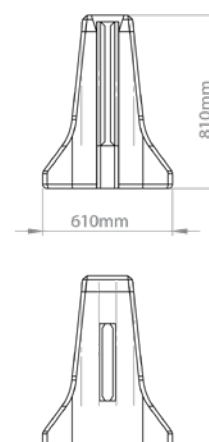
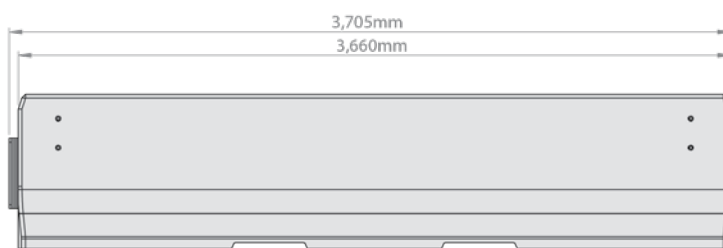



End Treatments



ABSORB 350



ABSORB 350 is designed to shield the end of temporary barrier systems such as our Ironman Hybrid Barrier and our T-Lok (PCB) Barrier.

This end terminal has an Austroads legacy status. It may still be suitable for some projects.

Absorbs are considered to be gating and non-redirective so site specific risk assessments are usually advised and length of need and barrier overrun becomes critical in your calculations.

The units are freestanding and very quickly deployed and installed.

Approved by



SPECIFICATIONS

TL-3 Length	6.88m (including transition)
Width	610mm
Height	813mm
Successfully Tested To	80km/h
ASBAP Approved To	70km/h
Material	UV Stabilized Polyethylene
Fill	Water
After Impact	Easily Replaced
Tested To	NCHRP350 TL-3
Durable	Yes
Fast and Easy Deployment and Retrieval	Yes
No Foundation Anchoring	Yes
Minimum Installation Exposure Time	Yes
Redirective	No
Reusable	Nose and transition can be reused after most impacts
USA Designed/Manufactured	Yes

- ✓ Easily replaced after impact
- ✓ Easy to remove and relocate or shift barriers for multi staged projects
- ✓ Durable
- ✓ Fast deployment and retrieval
- ✓ No anchoring required
- ✓ Maintenance free
- ✓ Water filled
- ✓ No machine required to install



SLED



SLED is compatible with the HV2 Barrier, concrete temporary barriers such as T-LOK and our Ironman Hybrid Barrier.

The SLED's unique design incorporates four internal steel cables, which help envelop the impacting vehicle - reducing the possibility of secondary accidents.

This end terminal has an Austroads Safety Barrier Assessment Panel (ASBAP) approval to 80km/h.

Approved by



SPECIFICATIONS

TL-3 Length	7.7m (7.92m including transitions)
Width	685mm
Height	1066mm
Successfully Tested To	100km/h
ASBAP Approval To	80km/h
Material	UV Stabilized Polyethylene
Fill	Water
After Impact	Easily Replaced
Tested To	MASH TL-3
Durable	Yes
Fast and Easy Deployment and Retrieval	Yes
No Foundation Anchoring	Yes
Minimum Installation Exposure Time	Yes
Redirective	No
Reusable	Nose and Transition Can Be Re-used After Most Impacts
USA Designed/Manufactured	Yes

- ✓ Successfully tested to MASH TL-3
- ✓ Fast deployment and retrieval
- ✓ No anchoring required
- ✓ Water filled
- ✓ Non re-directive
- ✓ Can be used in 40, 60 and 80 km/h zones (by adding or reducing modules)

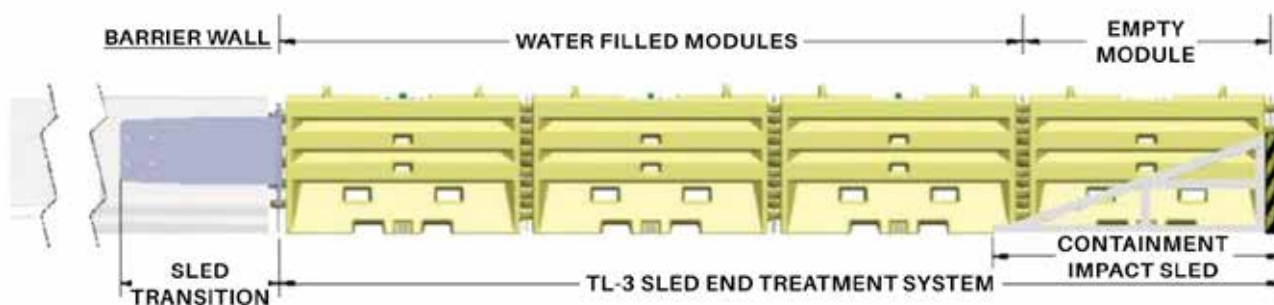
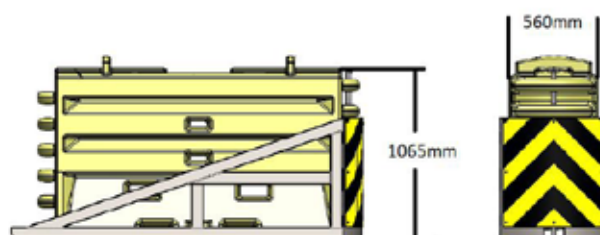

Please note: All systems require the front module to be empty.
See website (roadsafetyrental.com.au/sled) to view TL-1 and TL-2 configurations.

QuadGuard M10 CZ



When impacted from the side, the modular design system safely re-directs errant vehicles, so these systems offer superior protection and safety for work sites, and considered non-gating and fully re-directive.

This end terminal has an Austroads Safety Barrier Assessment Panel (ASBAP) approval to 100km/h.

Our fleet consists of several 100km/h units where maximum protection and safety is required and for any high speed applications or where non-gating end treatments are critical.

Approved by



SPECIFICATIONS

TL-3 Length	6740mm (excl transitions)
Width	System 610mm Plate: 1050mm
Height	817mm
Successfully Tested To	100km/h
ASBAP Approved To	100km/h
Material	Galvanised Steel
Fill	Energy Absorbing Cartridges
After Impact	Easily Repaired & Reinstated
Tested To	MASH TL-3
Durable	Yes
Redirective	Yes
Reusable	80% Reusable after most impacts
USA Designed/Manufactured	Yes
Safe Redirection	Yes
Fast Deployment/Retrieval	No
Anchoring Required	Yes
Economical To Transport	Yes
Maintenance Free	Yes
Durable	Yes

- ✓ Non-gating and fully re-directive behind nose cone
- ✓ 80% reusability after most impacts
- ✓ Successfully tested to MASH TL-3
- ✓ Durable
- ✓ Maintenance free
- ✓ Easy to reinstate and repair (after most impacts)
- ✓ Also available in 80km/h/ "4-bay" configuration
- ✓ USA designed and manufactured





VMS

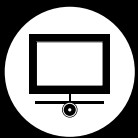

Variable Message Sign - Amber

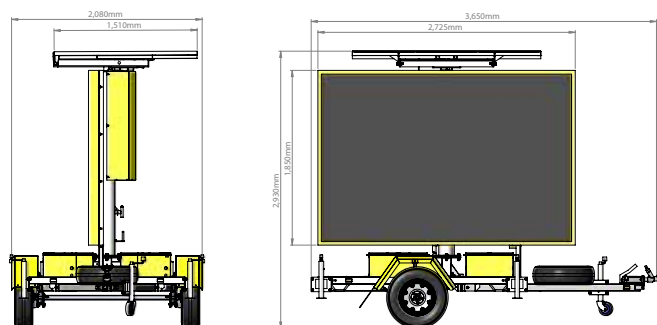

Our fleet consists of Australian designed and built VMS units, with an array of Amber boards to suit your project demands. We offer full message management capabilities, excellent backup support and after hours emergency care. All VMS units are full size units. We will deliver or you can collect from our yard by arrangement. All VMS are factory fitted with GPS and are also fitted with an array of anti-theft devices. Features a live monitoring system including GPS location, power usage, solar intake and mobile comms levels, all managed by our dedicated team.

- ✓ C-Size VMS
- ✓ Made to the highest quality standards
- ✓ Amber Display (400mm character height)
- ✓ Heavy Duty
- ✓ Fully galvanised and powder coated
- ✓ Australian designed and built
- ✓ Software allows pre-programming and ongoing message management by our team 24/7 nationwide
- ✓ 24/7 Australian support
- ✓ 4 x 12V 200AH batteries with on board battery charger
- ✓ 3 x 200W solar panels
- ✓ 48 x 28 full matrix LED pixels
- ✓ 360 degree rotatable display
- ✓ Fully sealed tool boxes with gas struts
- ✓ Checker plate floor

PRODUCT FEATURES & INCLUSIONS

LED Display
48 x 28 Full Matrix LED Pixels
400mm Character Height
Galvanised/Powder Coated Trailer with Extendable Stabilising Outriggers
On Board Battery Charger
Automatic Brightness/Dimming
No Software To Install
Solar Panel Tilt And Rotate On Most Units
360 Degree Rotatable Display
Checker Plate Floor
On-Board Message Manager
Fully Sealed Tool Boxes with Gas Struts
Program Using Any Tablet / smartphone
Remotely Monitor Battery Levels, GPS Location, Power Usage and Settings
Scheduling Software Allows Pre Programming
Spare Wheel
Radar System for Speed Monitoring - Optional

SPECIFICATIONS

Product Code	Amber F1504001C5
Weight (TARE)	1180kg
ATM	1500kg
Length Overall	3650mm
Width Overall	2080mm
Height Travelling	2930mm
Deployed Footprint Length	3650mm
Deployed Footprint Width	2725mm
Max Deployed Height	5300mm
Number of 12V 200AH Batteries	4
No. of 200W Solar Panels	3

Variable Message Sign - 5 Colour

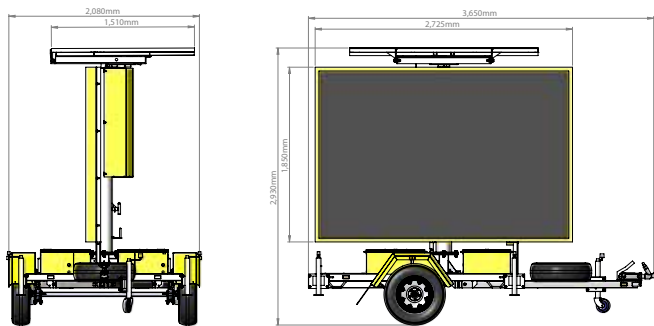

PRODUCT FEATURES & INCLUSIONS

LED Display
48 x 28 Full Matrix LED Pixels
400mm Character Height
Galvanised/Powder Coated Trailer with Extendable Stabilising Outriggers
On Board Battery Charger
Automatic Brightness/Dimming
No Software To Install
Solar Panel Tilt And Rotate On Most Units
360 Degree Rotatable Display
Checker Plate Floor
On-Board Message Manager
Fully Sealed Tool Boxes with Gas Struts
Program Using Any Tablet / smartphone
Remotely Monitor Battery Levels, GPS Location, Power Usage and Settings
Scheduling Software Allows Pre Programming
Spare Wheel
Radar System for Speed Monitoring - Optional

All VMS units are full size units. We will deliver or you can collect from our yard by arrangement. All VMS are factory fitted with GPS and are also fitted with an array of anti-theft devices. Features a live monitoring system including GPS location, power usage, solar intake and mobile comms levels.

- ✓ C-Size VMS
- ✓ Made to the highest quality standards
- ✓ 5 Colour Display (400mm character height)
- ✓ Heavy Duty
- ✓ Fully galvanised and powder coated
- ✓ Australian designed and built
- ✓ Software allows pre-programming and ongoing message management by our team 24/7 nationwide
- ✓ 24/7 Australian support
- ✓ 4 x 12V 200AH batteries with on board battery charger
- ✓ 3 x 200W solar panels
- ✓ 48 x 28 full matrix LED pixels
- ✓ 360 degree rotatable display
- ✓ Fully sealed tool boxes with gas struts
- ✓ Checker plate floor

SPECIFICATIONS

Product Code	Colour F1504001P
Weight (TARE)	1180kg
ATM	1500kg
Length Overall	3650mm
Width Overall	2080mm
Height Travelling	2930mm
Deployed Footprint Length	3650mm
Deployed Footprint Width	2725mm
Max Deployed Height	5300mm
Number of 12V 200AH Batteries	4
No. of 200W Solar Panels	3



Lighting & Security

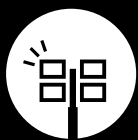

V20 Work Zone Light Tower

The lighting power of 4x300W LED floodlights is comparable to the one of a traditional 4x1000W metal halide lighting set, with diffuser lenses.

The V20 lighting tower is equipped with a low consumption diesel engine and Digital controller, specific for lighting trailers.

Engine runs on less than 0.6L per hour at full lighting capacity.

Please visit our website to view lighting charts.



- ✓ More than 180 hours of running time
- ✓ The lowest noise level - only 58 dB(A) @ 7 metres
- ✓ Safer low voltage LED - the LED floodlights are powered with 48 volts
- ✓ Easy to use digital control unit
- ✓ Easy access to control panel and two additional access doors to check engine if required
- ✓ Adjustable stabilisers allow the operator to level the V20 in only a few seconds
- ✓ Low fuel consumption

SPECIFICATIONS

Lifting system	Hydraulic
Min. dim.	220 x 140 x 244cm
Max. dim.	220 x 185 x 850cm
Dry weight	980kg
Lamps power (Hyper)	4 x 300W (with diffuser lenses)
Lamps type	LED
Certified illuminated area	3,900m2
Total lumen (Tc=25°)	153,000Lm
Mast rotation	340°
Certified wind speed resistance	110 km/h

Tank capacity	100 litre
Engine model	Kubota Z482 2 cyl. @1500 rpm
2 cyl. @1500 rpm	Yes
Engine cooling	Water
Alternator	2 kVA - 16 A - 230 V
Inlet socket	16 A - 230 V
Running time	180h
Avg. sound pressure level	58 dB(A) @ 7m
Trailers available	Road trailer or site-tow trailer
Fuel Efficiency	0.6L per hour at full load

Portable Solar Light

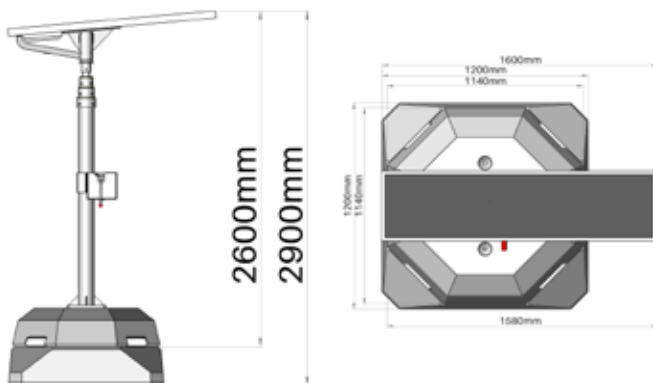
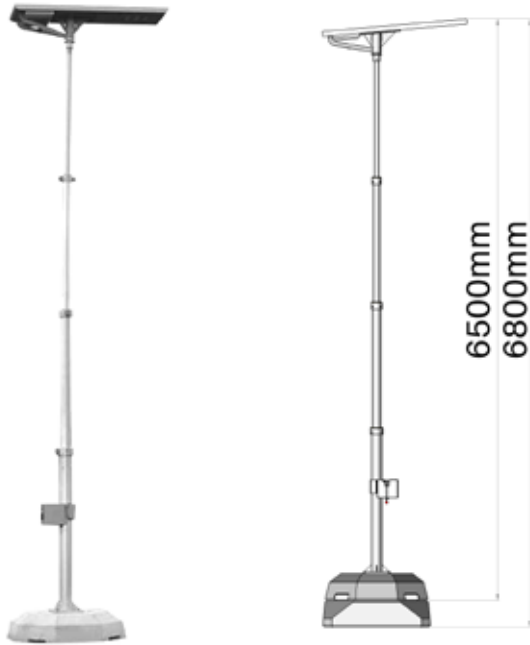

Our newest and most innovative solar lighting solution yet is a powerful 100W portable light. Extremely easy to transport and install, the telescopic pole allows set up in under two minutes. The concrete base sets a strong foundation making this solar light an extremely robust and dependable renting option, even in inclement weather. It is wind rated for Region A with the single concrete base option, and Regions B and C with the double concrete base.

Please visit our website to view additional specifications and lighting charts.

- ✓ Fully portable
- ✓ 100W all-in-one compact unit
- ✓ Mono-crystalline solar panel
- ✓ Telescopic light pole
- ✓ Winch from lowered to raised position in less than 2 minutes
- ✓ Extremely quick installation and removal
- ✓ Convenient to transport
- ✓ Built in lithium-ion battery storage
- ✓ Two concrete base options to suit different wind regions
- ✓ Built-in galvanised fork ports in base
- ✓ Heavy duty lifting lugs
- ✓ Strengthened with reo-bars running throughout base
- ✓ No diesel and no noise!
- ✓ Great for sites with ever changing lighting needs

Australian Wind Rating Guide



SPECIFICATIONS

Power Consumption	100W
Beam Angle	150° x 70°
Luminous Flux	14,000 Lm (TYP)
Colour Temperature	2700 - 6500K
Time to fully charge	8 hours
Battery	Lithium life PO4
Single concrete base (Wind Rating: Region A)	720kg
Double concrete base (Wind Rating: Region B & C)	1720kg



Event Security



BIG Blockout



Saferoads has developed a sturdy barrier system for any circumstance, including and not limited to site work, delineation, shielding or simply for lower speed and offline sections of work areas that require separation from pedestrians or ongoing traffic. These barriers are convenient to deploy and also lend themselves to event management applications.

- ✓ Australian designed and manufactured
- ✓ Extra durable, robust, virtually indestructible!
- ✓ Highest quality plastic barriers available
- ✓ Segments are 2m in length
- ✓ Bright orange colour for high visibility on site
- ✓ 8mm wall thickness
- ✓ User friendly to stack
- ✓ Innovative tapered interlocking tabs are efficient to use
- ✓ Suitable for all environments
- ✓ Each join allows for 300 degree angling

SPECIFICATIONS

Height	940mm
Height of 2 Stacked Units	1840mm
Overall Length	2200mm
Installed Length	2050mm
Width	390mm
Weight (empty)	38kg
Weight (full)	488kg
Water Ballast	450L
Wall Thickness	8mm

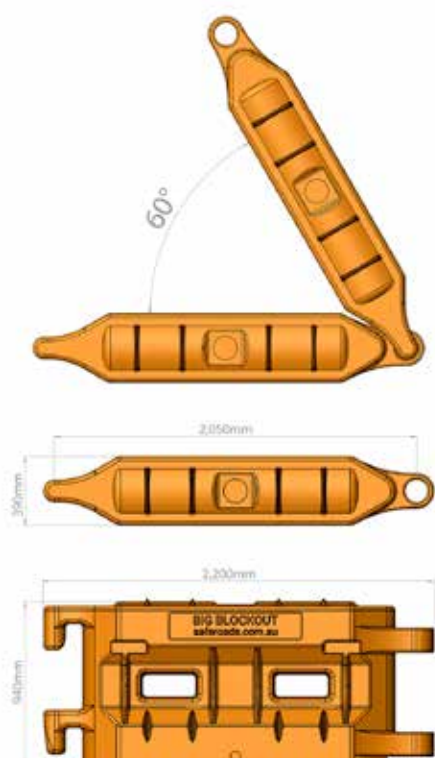

OmniStop Portable System



AUSTRALIAN INNOVATION TO PROTECT PEDESTRIANS AT EVENTS

That's why our fleet at Road Safety Rental offers the OmniStop Portable System. This temporary bollard system stops vehicles in their tracks, and is fully portable. It offers event managers an innovative solution to protecting the public from terrorists and errant drivers, without interfering with pedestrian activity. The product has been designed to offer maximum protection, quick deployment and peace of mind for event organisers and patrons for any sizable event or festival.

Benefits of choosing the OmniStop Portable System include:

Reliable

OmniStop Portable Security Bollard has been independently crash tested to confirm it can stop a 2270kg pickup traveling at 60km/h. For full details refer to NATA test report 21140

Unobtrusive

OmniStop Portable Security Bollard is unobtrusive and allowing free flow of foot traffic through the system, even allowing easy access for prams and wheelchairs. It does not inhibit the timely evacuation of pedestrians in case of an emergency.

Completely Portable

OmniStop Portable Security Bollard is freestanding and unanchored, which allows easy installation for temporary applications - the only requirement is a flat surface!

Disabled and Emergency Access

OmniStop Portable Security Bollards low height module allows for simple and easy disabled and emergency access.



SPECIFICATIONS

Length	3088mm
Width	1150mm
Height	1076mm
Weight	1250kg (per 3m segment)
Bollard Diameter	150mm

- ✓ Fully crash tested with a 2270kg vehicle at 60km/h
- ✓ PAS Rating: N1G - 48 (2500kg 4x4 Dual Cab Pickup) @48kph
- ✓ Portable
- ✓ Protects people
- ✓ Allows pedestrian flow
- ✓ Stops errant vehicles
- ✓ Easy, quick installation
- ✓ Affordable

OmniStop Portable System

STANDARD

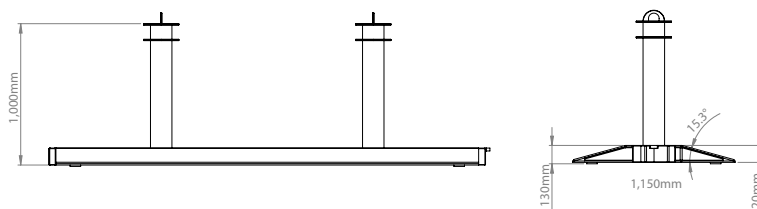

DISABLED ACCESS

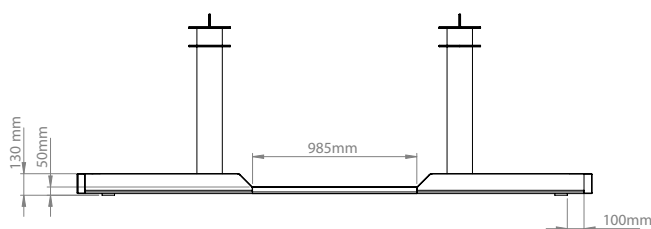

EMERGENCY ACCESS

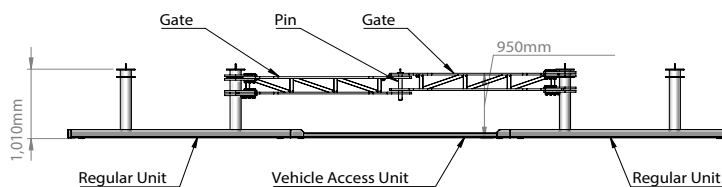



Locations

Road Safety Rental VIC

69A Nar Nar Goon Road
Nar Nar Goon VIC 3812
(03) 5945 6601

Road Safety Rental NSW

68 Turner Road,
Gregory Hills, NSW 2557
(02) 4610 5993

Road Safety Rental QLD

50-66 Flame Trees Drive,
Luscombe, QLD 4207

The Work Zone Specialists

roadsafetyrental.com.au

1800 ROAD SAFETY
1800 762 372